

SECTION 5



SIZE LIMITATIONS

The maximum sizes stated below are based on 28mm 4-20-4 standard double glazed units within frames manufactured to the reinforcement guidelines.

Max Weight - 56kg/door

Fig. 1 - 4-20-4 Glazed Unit

Panel Weight (kg)		Sash Width (mm)								
		600	650	700	750	800	850	900	950	1000
Sash Height (mm)	2250	27.0	29.3	31.5	33.8	36.0	38.3	40.5	42.8	45.0
	2200	26.4	28.6	30.8	33.0	35.2	37.4	39.6	41.8	44.0
	2150	25.8	28.0	30.1	32.3	34.4	36.6	38.7	40.9	43.0
	2100	25.2	27.3	29.4	31.5	33.6	35.7	37.8	39.9	42.0
	2050	24.6	26.7	28.7	30.8	32.8	34.9	36.9	39.0	41.0
	2000	24.0	26.0	28.0	30.0	32.0	34.0	36.0	38.0	40.0

Fig. 2 - 6.4-20-4 Glazed Unit

Panel Weight (kg)		Sash Width (mm)								
		600	650	700	750	800	850	900	950	1000
Sash Height (mm)	2250	33.8	36.6	39.4	42.2	45.0	47.8	50.6	53.4	56.0
	2200	33.0	35.8	38.5	41.3	44.0	46.8	49.5	52.3	55.0
	2150	32.3	34.9	37.6	40.3	43.0	45.7	48.4	51.1	53.8
	2100	31.5	34.1	36.8	39.4	42.0	44.6	47.3	49.9	52.5
	2050	30.8	33.3	35.9	38.4	41.0	43.6	46.1	48.7	51.3
	2000	30.0	32.5	35.0	37.5	40.0	42.5	45.0	47.5	50.0

Maximum sash height and widths are stated in fig.1 & 2
Panel weights are not to exceed the maximum weight specified

LBF045/LBF045L Size range:
1795mm - 2135mm (overall frame size)

LBF049, Espag Extension used on doors above 2135mm

MEETING STILE END CAP

Bi-Fold Plus Fabrication Manual Update May '11

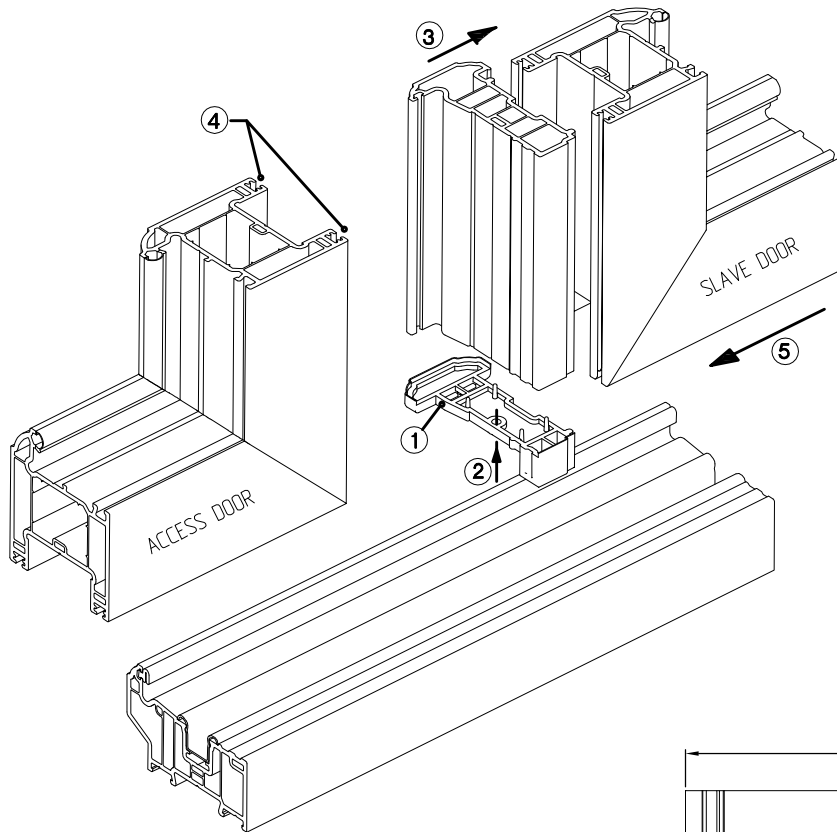

Meeting Stile End Cap Assembly

1. Brush pile LBF196 (25mm length), inserted into each end cap (see diagram).
2. Screw end caps onto meeting stile.
3. Locate and secure meeting stile LBF191 onto slave door.
4. Brush pile LBF196 used in both vertical sash legs on 'access door', detailed in section 3.

Low Threshold Step Only

5. Slide slave door sash gasket into end cap upto stop (shown below).

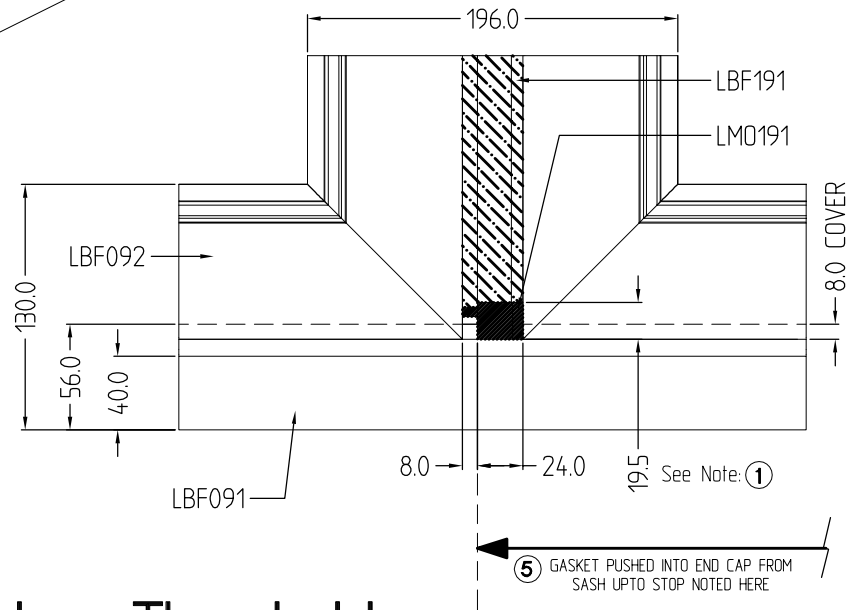

Optional Alum. Low Threshold

Gasket Detailing

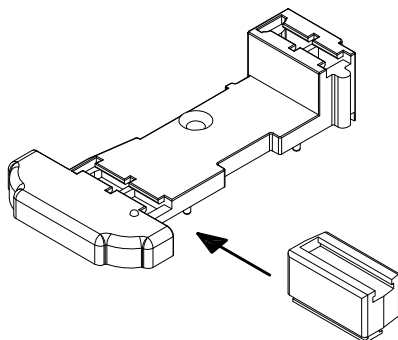

When the Liniar Bi-Fold Plus door is used in conjunction with the aluminium low threshold (LBF291) and a meeting stile, an extra step is required.

Due to the low threshold not having a rebate, an extra 'threshold gasket block' is supplied. This block is provided with the end caps, and is fitted into the front slot of the meeting stile end cap.

Once this block is installed (on the bottom end cap only) it will allow the gasket in the sash to be continued into the end cap, and pushed up to the stop. As noted above in detail 5.

LOW THRESHOLD ASSEMBLY

Bi-Fold Plus Fabrication Manual Update May '11



Gasket Detailing (Threshold Only)

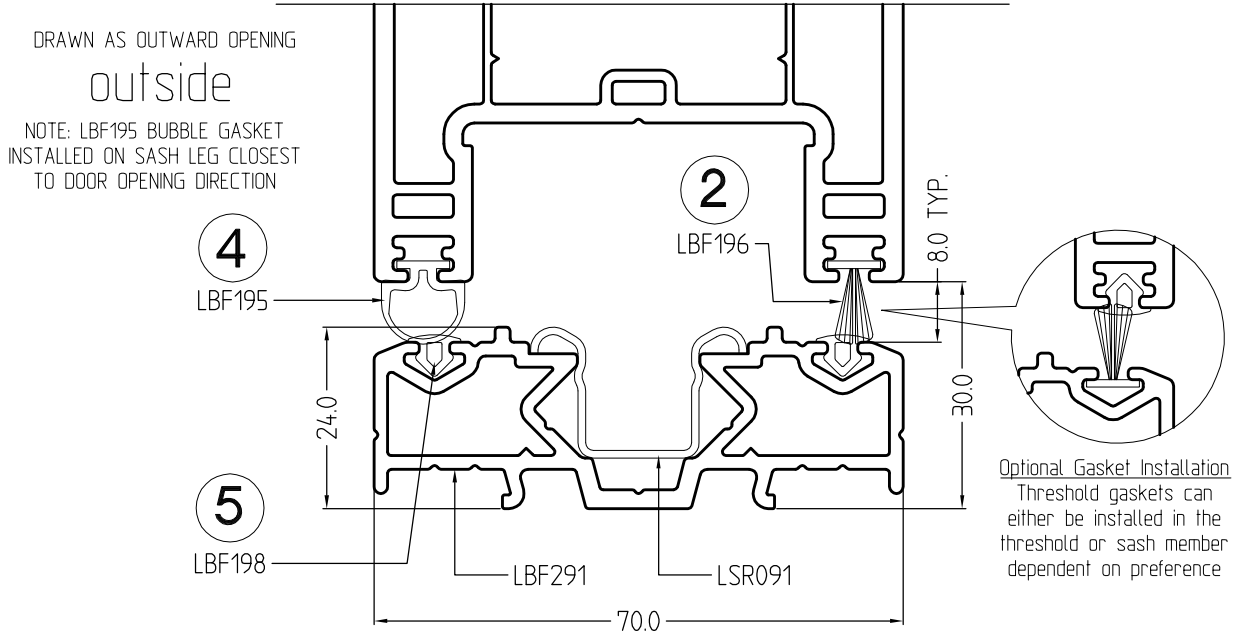

Optional Alum. Low Threshold Tray

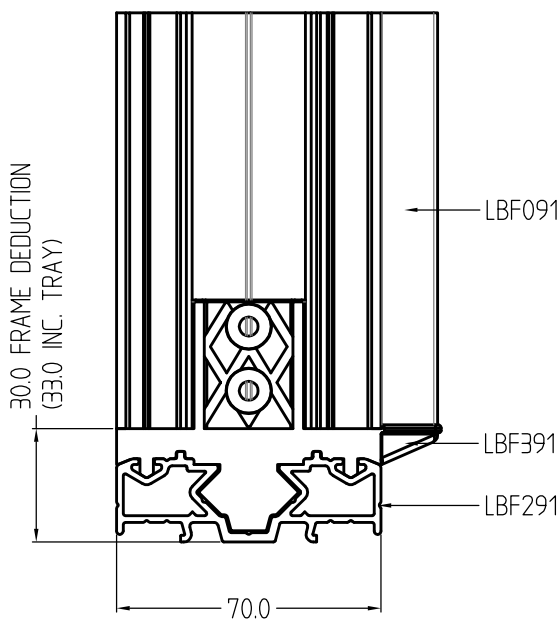
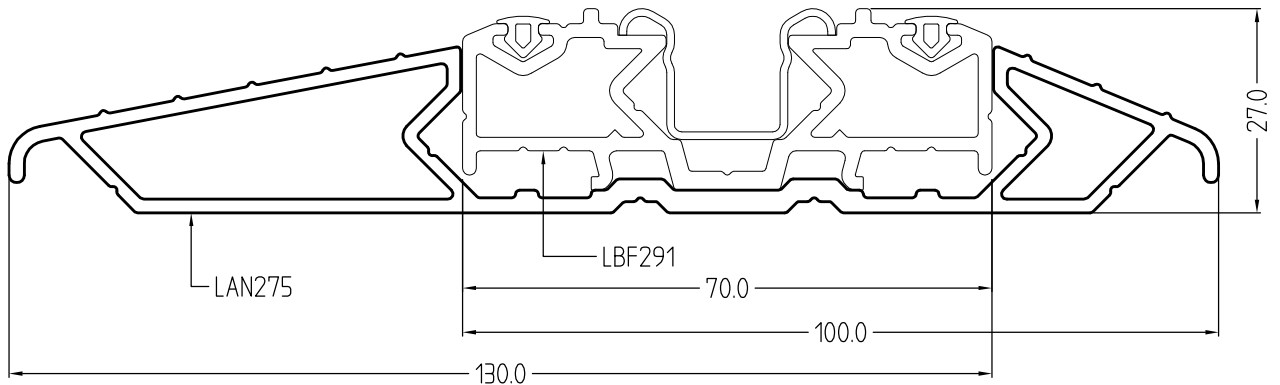

Low Threshold Moulding Assembly

1. Align moulding on threshold and screw into position to fix.
2. Drill thru' from top using 5mm dia. drill.
3. Align outer frame onto moulding.
4. Screw frame into position through the side of the moulding (2 off.).
5. Screw from the underside of the threshold into outer frame (2 off.).

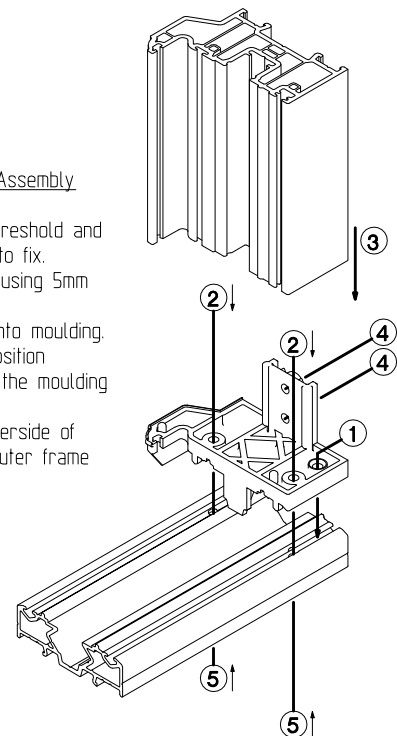

DRAINAGE

Bi-Fold Plus Fabrication Manual Update May '11
(reinforcement shown for reference only)

Drainage Slot Typically: 30mm x 5mm wide
Pressure Equalization Typically: 30mm x 5mm wide
* Track Drainage: 16mm x 16mm wide

CONCEALED DRAINAGE

EXT. FOLDING

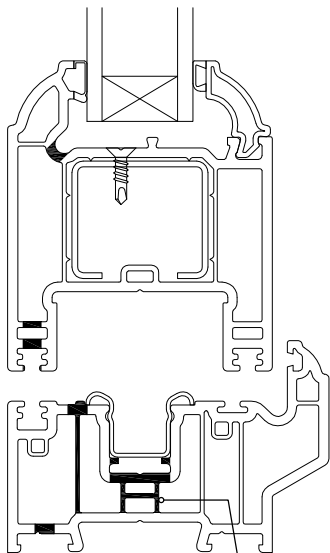
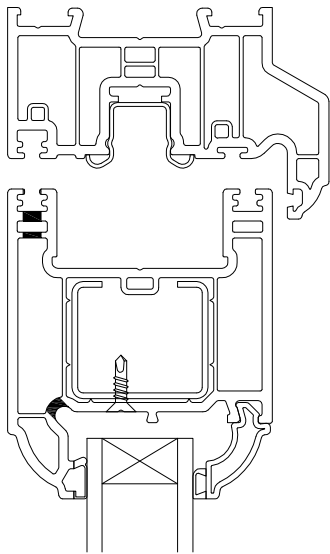

INT. FOLDING

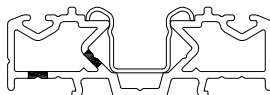
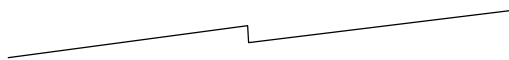
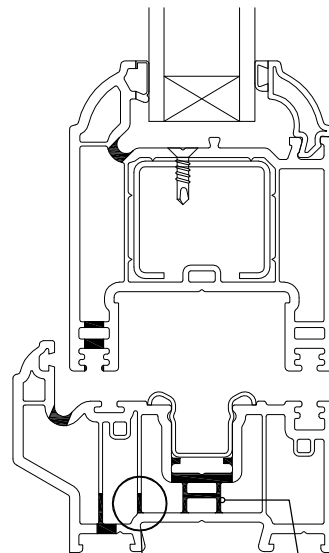
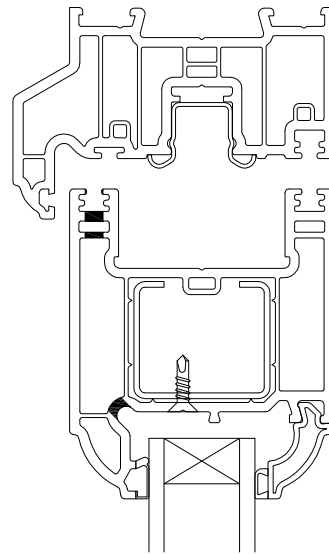

ALUM. LOW THRESHOLD DRAINAGE

Remove web in areas circled
Each end 5mm deep before
welding

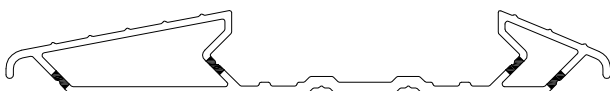

TRAY DRAINAGE
(DRAIN FRONT OR REAR IN 2 PLACES
AS SHOWN DEPENDANT ON ASSEMBLED
ORIENTATION)

FACE DRAINED

EXT. FOLDING

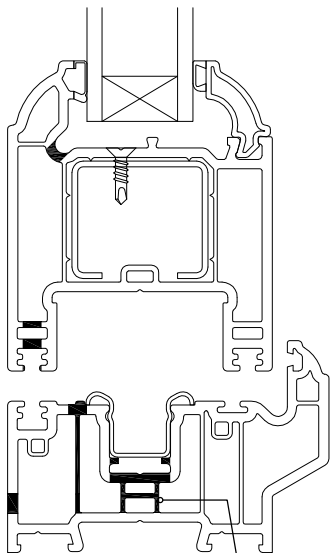
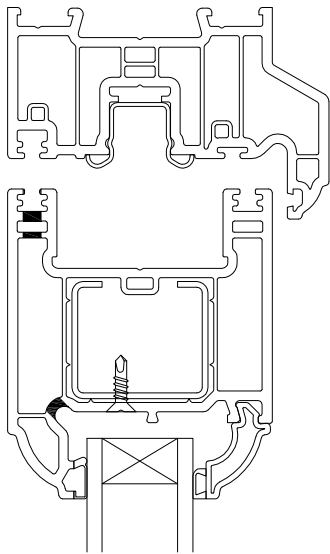

INT. FOLDING

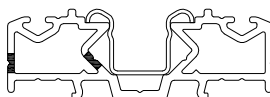
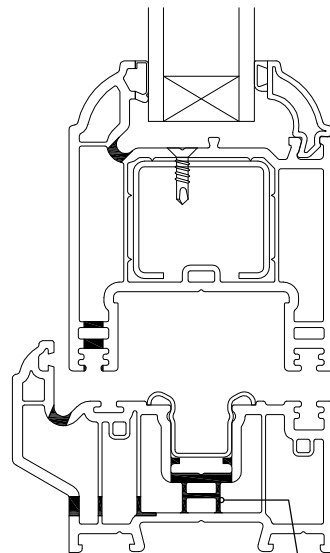
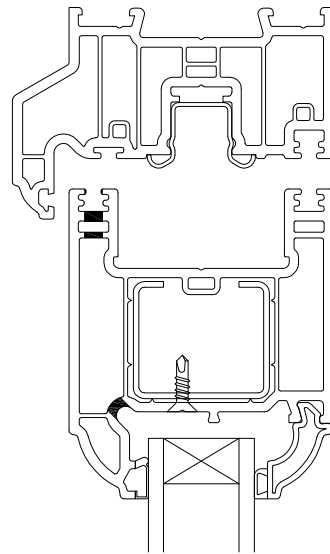

ALUM. LOW THRESHOLD DRAINAGE

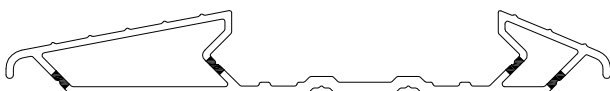

TRAY DRAINAGE
(DRAIN FRONT OR REAR IN 2 PLACES
AS SHOWN DEPENDANT ON ASSEMBLED
ORIENTATION)